



D BALAJI PIPE FITTINGS



Quality With Integrity.





Company Profile

D BALAJI PIPES & FITTINGS is a well known Importers, Manufacturer, Stockiest, Supplier and Exporter of Raw materials like Long Radius Bends, Compression Tube Fittings, Pipe Fittings, Forged Fittings, Flanges, Shims & Plates, Fasteners, Pipes & Tubes, Round Bars & Wire, Flat Bars etc.

D BALAJI PIPES & FITTINGS And Has A Track Record Of Offering A Wide Range Of Piping Solution At Very Competitive Prices. In A Very Short Period Of Time, We Have Gained An Excellent National And International Reputation.

We Are Able To Satisfy The Needs Of Our Clients In A Timely And Systematic Manner. The Profound Knowledge And Rich Experience of Our Team in The Respective Arena Of Metal Products Has Assisted The Company To Acquire Distinguished Position Amidst The Reliable Piping Solutions in India & All Over World.

We Export 60% Of Our Range Of Flanges, Outlets, Pipe Fittings And Forged Fittings To Many Countries Like Europe, Saudi Arabia, Qatar, Australia, Brazil, UK, USA Etc. We Would Appreciate To Get Your Esteemed Enquires And Look Forward To The Pleasure Receiving Your Valuable Response.

We Are Regularly Supplying These Items To Many Leading Industrial Units Consisting Of : Ship Building, Petrochemical Plants, Steel Plants, Refineries, Chemicals, Fertilizers, Power Plant, Pharmaceutical, Ports, Oil & Gas, Railway, Mining, Cement Plants, Paper Mills, Sugar Mills, Fabrication Units Etc.

Especially Stainless Steel Sheets/ Plates/ Coils/ Pipes To Engineering Industries Who Are Engage In The Manufacture And Fabrication Of Process Equipment. We Can Supply The Items Even Under Third Party Inspection Viz Bureau Veritas, D.N.V., Kavernor Power Gas, Udhe India, EIL, Lloyds, Toyo, Chemtex, Ceil, Tecnimont, IBR Etc.

We hope the information provide is useful to you & will forward us your regular enquires and requirement & provide us with an opportunity to work with your esteemed organisation.

If you have any suggestion or query, on how we can serve you better please do inform us. Your suggestions are heartily welcomed.





D BALAJI

PIPE FITTINGS

HOUSE OF STAINLESS STEEL

Manufacturers of :

Stainless Steel Pipe & Fittings, Butt Weld Fittings,
Dairy Fittings, Socket Weld & Forge Fittings.

Stockist, Dealers & Suppliers of :

Stainless Steel Pipe and Tubes (Seamless and Welded) Sheet,
Plate, Coils, Rods, Angle, Channel, Valves, Perforate Sheets, Wire and
Wiremesh Industrial Raw Materials in Ferrous & Non-ferrous Metals.

Old No. 202/232, Linghi Chetty Street, Shop No. 2 & 3, Chennai - 600 001.
T/Fax: 044-2522 8081 * P: 044-4216 2308 / 4215 9085

140, FF, Suvan Business Park, Nr. Kewal Kanta, Rakhial,
Ahmedabad - 380 023. Mob.: 88255 29011

Factory : Pato Pandora Tatah Voki Rada Road, Magan Fest,
Munchal, Maharashtra - 401 202.

Call : +91 9962492282 / 98847 330542

Whatsapp : +91 9444522558 / 6374260316

E-mail : dbalajipipes2008@gmail.com | dbalajipurohit2008@yahoo.in
internationaldbalaji2008@gmail.com

Web. : www.dbpipefittings.in



Quality Policy



As per our corporate philosophy, we will always strive

- To improve the internal procedure control and to strengthen the communication and management.
- Make best of our effort to deliver high value added products to broaden the service scope.
- To promote wide variety of value added service and to make sure all customers requirements are met on time.
- Promoting technical skill to higher level and continuously putting the concept of "Quality that inspires the customer confidence".

Vision

To become an enterprising organization in the field of Pipes and Tubes Products.
To be Known for quality of products
And Excellent Service

Mission

To Satisfy our Clients needs by Providing High Quality Products at Competitive Price as per the Schedule and to Maintain long Term Relationship With our Clients

Testing Facility Available

- Chemical Analysis
- Radiography
- Corrosion Test
- Hydrostatic
- Mechanical Test
- Ultrasonic Test

Quality Assurance

We strive to deliver an unmatched quality range of Metal Products to our clients. We bring out the best of us to achieve the utmost quality standards. There is a team of quality auditors, who put in lots to bring forth a qualitative range of products, which is in adherence to the global quality standards. They make these products to pass through rigorous quality tests, so as to avoid the chance of any defect in our product range. Our products are tested on various internationally accepted parameters, which are as follows :

- » Durability
- » Strength
- » Wear & Tear Resistance
- » Corrosion Resistance
- » Malleability and Ductility





BUTT-WELD FITTINGS

Stainless Steel & Duplex Steel

- Stainless Steel : ASTM A 403 WP - 304/304H304L/316/316H
316/316Ti, 309, 310, 317L, 321, 347, 904L
- Duplex & Super Duplex : Standard
ASTM A815 - UNS S31803, S32205 (2205)
Lean
ASTM A 815, 790 - UNS S32304 (2304)
Super Duplex
ASTM A815 790 - UNS S32750 (2507)
UNS S32760 (Zeron 100)

Hi-Nickel & Titanium

Hi-Nickel

- Nickel : ASTM B 366 N02200, N02201
- Inconel : ASTM B 366 N06600, N06601, N06617
ASTM B 366 N07718, ASTM B 366 N06625
- Incoloy : ASTM B 366 N08800, N08810
ASTM B 366 N08825, ASTM B 366 N08020
- Hastelloy : ASTM B 366 N10276, N06022
ASTM B366 N10665, ASTM B 366 N06455

Titanium

- Commercially : ASTM B 363
- Titanium Pure : Gr.1 R 56250 (CP4) Gr.2 R 50400 (CP3)
Gr.3 R 50550 (Cp2) Gr.4 R 50700 (Cp1)
Gr.7 R 52400 Gr.11 R 52250
- Titanium Alloys : ASTM B 363
Gr.5 R 56400 (6Al-4V)
Gr.23 R 56401 (6Al-4V-ELI)
Gr.12 R 53400

Cupro Nickel

- ASTM B 466 C70600 (90:10), ASTM B 466 C71500 (70:30)

Monel

- ASTM B 366 N04400, DIN N05500

Alloy Steel, Carbon Steel & LTCS

- Alloy Steel : ASTM A 234 WPB WP 5, WP 9, WP 11,
WP 12, WP 22, WP 91
- Carbon Steel : ASTM A234 WPB, IS 1239 PART II
- Low Temp. CS : ASTM A-420 WPL6
- Other Service : Hot Dip Galvanizing, Sand Blasting

Size

- Fittings : Seamless 15NB To 600NB
Split / Welded 100NB To 1200NB
- Schedule : Sch. 5 to Sch. XXS

Types

- Stubend - (Long & Short) Elbow (45 DEG, 90 DEG, 180 DEG)
- U Bend Tee - (Barred, Equal, Reducing)
- End Cap Reducer - (Concentric & Eccentric)
- Laterals Nipple - (swage & Barrel)

Test Certificate

- Manufacturer Test Certification (En 3.1 & 3.2, IBR Test Certificate)

Specializing in :

Hi-Nickel & Stainless Steel Series

- Inconel*, Incoloy*, Monel*, Hastelloy*, Duplex*,
are Registered Trade Marks of their Respective Owners.

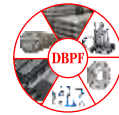

DIMENSIONS OF BUTT-WELDING FITTING ANSI B-16.9 / B-16.28 / MSS SP 43

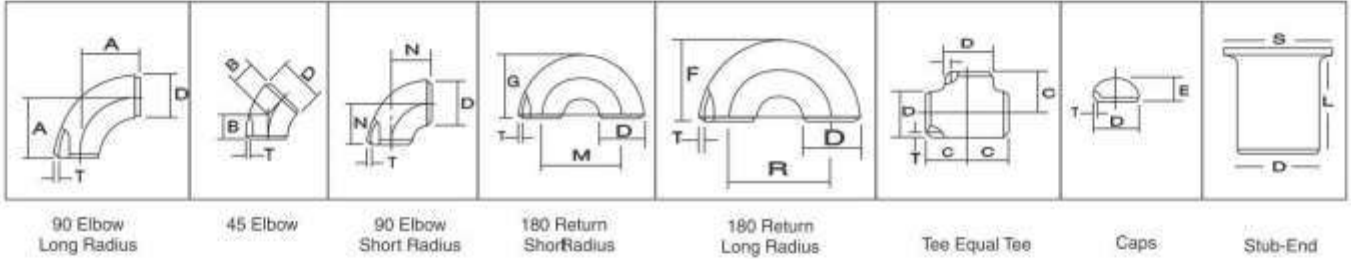

Nominal Pipe Size		Outside Diameter	Center to Face				Back to Face			Center to Center			Length 'L'	
INCH	MM	D	A R=1.5D	B	C	N R=1D	E	F	G	R	M	S	Short L	Long L
1/2	15	21.3	38.00	16.0	25.0	-	25.0	48.0	-	76.0		35.0	50.8	76.2
3/4	20	26.7	29.00	11.0	29.0	-	25.0	43.0	-	57.0		43.0	50.8	76.2
1	25	33.4	38.00	22.0	38.0	25.0	38.0	56.0	41.0	76.0	51.0	51.0	50.8	101.6
1.1/4	32	42.2	48.00	25.0	48.0	32.0	38.0	70.0	52.0	95.0	64.0	64.0	50.8	101.6
1.1/2	40	48.3	57.15	29.0	57.0	38.0	38.0	83.0	62.0	114.0	76.0	73.0	50.8	101.6
2	50	60.3	76.00	35.0	64.0	51.0	38.0	106.0	81.0	152.0	102.0	93.0	63.5	152.4
2.1/2	65	73.0	95.25	44.0	76.0	64.0	38.0	132.0	100.0	191.0	127.0	105.0	63.5	152.4
3	80	88.9	114.30	51.0	86.0	76.0	51.0	159.0	121.0	229.0	152.0	127.0	63.5	152.4
3.1/2	90	101.6	133.35	57.0	95.0	89.0	64.0	184.0	140.0	267.0	178.0	140.0	76.2	152.4
4	100	114.3	152.0	64.0	105.0	102.0	64.0	210.0	159.0	305.0	203.0	157.0	76.2	152.4
5	125	141.3	190.0	79.0	123.0	127.0	76.0	262.0	197.0	381.0	254.0	186.0	76.2	203.2
6	150	168.3	229.0	95.0	143.0	152.0	89.0	313.0	237.0	457.0	305.0	218.0	88.9	203.2
8	200	219.1	305.0	127.0	178.0	203.0	102.0	414.0	313.0	610.0	406.0	270.0	101.6	203.2
10	250	273.1	381.0	159.0	216.0	254.0	127.0	515.0	391.0	762.0	508.0	324.0	127.0	254.0
12	300	323.8	457.0	190.0	254.0	305.0	152.0	619.0	467.0	914.0	610.0	381.0	152.4	254.0
14	350	355.6	533.0	222.0	279.0	356.0	165.0	711.0	533.0	1067.0	711.0	413.0	152.4	305.0
16	400	406.4	610.0	254.0	305.0	406.0	178.0	813.0	610.0	1219.0	813.0	470.0	152.4	305.0
18	450	457.2	686.0	286.0	343.0	457.0	203.0	914.0	686.0	1372.0	914.0	533.0	152.4	305.0
20	500	508.0	762.0	318.0	381.0	508.0	229.0	1016.0	762.0	1524.0	1016.0	584.0	152.4	305.0
22	550	559.0	838.0	343.0	419.0	559.0	254.0	1118.0	838.0	1676.0	1118.0	614.4	152.4	305.0
24	600	610.0	914.0	381.0	432.0	610.0	267.0	1219.0	914.0	1829.0	1219.0	692.0	152.4	305.0
26	650	660.0	991.0	405.0	495.0	660.0	267.0							
28	700	711.0	1067.0	438.0	521.0	771.0	267.0							
30	750	762.0	1143.0	470.0	559.0	762.0	267.0							
32	800	813.0	1219.0	502.0	597.0	813.0	267.0							
34	850	864.0	1295.0	533.0	635.0	864.0	267.0							
36	900	914.4	1372.0	565.0	673.0	914.0	267.0							



All Dimensions in Millimeters



DIMENSIONS OF BUTT-WELDING FITTING ANSI B-16.9 / B-16.28

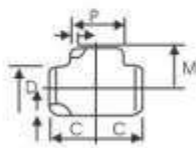

REDUCING TEES

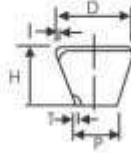

CONCENTRIC REDUCERS

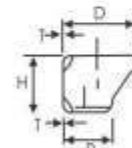

ECCENTRIC REDUCERS

Nominal Pipe Size		Outside Diameter		Center to End		Length
INCH	MM	D	P	C	M	H
1/2 x 3/8	15 x 10	21.3	17.1	25	25	-
1/2 x 1/4	15 x 8	21.3	13.7	25	25	-
3/4 x 1/2	20 x 15	26.7	21.3	29	29	38
3/4 x 3/8	20 x 10	26.7	17.1	29	29	38
1 x 3/4	25 x 20	33.4	26.7	38	38	51
1 x 1/2	25 x 15	33.4	21.3	38	38	51
1 1/4 x 1	32 x 25	42.2	33.4	48	48	51
1 1/4 x 3/4	32 x 20	42.2	26.7	48	48	51
1 1/4 x 1/2	32 x 15	42.2	21.3	48	48	51
1 1/2 x 1 1/4	40 x 32	48.3	42.2	57	57	64
1 1/2 x 1	40 x 25	48.3	33.4	57	57	64
1 1/2 x 3/4	40 x 20	48.3	26.7	57	57	64
1 1/2 x 1/2	40 x 15	48.3	21.3	57	57	64
2 x 1 1/2	50 x 40	60.3	48.3	64	60	76
2 x 1 1/4	50 x 32	60.3	42.2	64	57	76
2 x 1	50 x 25	60.3	33.4	64	51	76
2 x 3/4	50 x 20	60.3	26.7	64	44	76
2 1/2 x 2	65 x 50	73.0	60.3	76	70	89
2 1/2 x 1 1/2	65 x 40	73.0	48.3	76	67	89
2 1/2 x 1 1/4	65 x 32	73.0	42.2	76	64	89
2 1/2 x 1	65 x 25	73.0	33.4	76	57	89
3 x 2 1/2	80 x 65	88.9	73.0	86	83	89
3 x 2	80 x 50	88.9	60.3	86	76	89
3 x 1 1/2	80 x 40	88.9	48.3	86	73	89
3 x 1 1/4	80 x 32	88.9	42.2	86	70	89
4 x 3 1/2	100 x 90	114.3	101.6	105	102	102
4 x 3	100 x 80	114.3	88.9	105	98	102
4 x 2 1/2	100 x 65	114.3	73.0	105	95	102
4 x 2	100 x 50	114.3	60.3	105	89	102
4 x 1 1/2	100 x 40	114.3	48.3	105	86	102
5 x 4	125 x 100	141.3	114.3	124	117	127
5 x 3 1/2	125 x 90	141.3	101.6	124	114	127
5 x 3	125 x 80	141.3	88.9	124	111	127
5 x 2 1/2	125 x 65	141.3	73.0	124	108	127
5 x 2	125 x 50	141.3	60.3	124	105	127
6 x 5	150 x 125	168.3	141.3	143	137	140
6 x 4	150 x 100	168.3	114.3	143	130	140
6 x 3 1/2	150 x 90	168.3	101.6	143	127	140
6 x 3	150 x 80	168.3	88.9	143	124	140
6 x 2 1/2	150 x 65	168.3	73.0	143	121	140

All Dimensions in Millimeters

Nominal Pipe Size		Outside Diameter		Center to End		Length
INCH	MM	D	P	C	M	H
8 x 6	200x150	219.1	168.3	178	168	152
8 x 5	200 x 125	219.1	141.3	178	162	152
8 x 4	200 x 100	219.1	114.3	178	156	152
8 x 3 1/2	200 x 90	219.1	101.6	178	152	152
10 x 8	250 x 200	273.1	219.1	216	203	178
10 x 6	250 x 150	273.1	168.1	216	194	178
10 x 5	250 x 125	273.1	141.3	216	191	178
10 x 4	250 x 100	273.1	114.3	216	184	178
12 x 10	300 x 250	323.9	273.1	254	241	203
12 x 8	300 x 200	323.9	219.1	254	229	203
12 x 6	300 x 150	323.9	168.3	254	219	203
12 x 5	300 x 125	323.9	141.3	254	216	203
14 x 12	350 x 300	355.6	323.9	279	270	330
14 x 10	350 x 250	355.6	273.1	279	257	330
14 x 8	350 x 200	355.6	219.1	279	248	330
14 x 6	350 x 150	355.6	168.3	279	238	330
16 x 14	400 x 350	406.4	355.6	305	305	356
16 x 12	400 x 300	406.4	323.9	305	295	356
16 x 10	400 x 250	406.4	273.1	305	283	356
16 x 8	400 x 200	406.4	219.1	305	273	356
16 x 6	400 x 150	406.4	168.3	305	264	356
18 x 16	450 x 400	457.0	406.4	343	330	381
18 x 14	450 x 350	457.0	355.6	343	330	381
18 x 12	450 x 300	457.0	323.9	343	321	381
18 x 10	450 x 250	457.0	273.1	343	308	381
18 x 8	450 x 200	457.0	219.1	343	298	381
20 x 18	500 x 450	508.0	457.0	381	368	508
20 x 16	500 x 400	508.0	406.4	381	356	508
20 x 14	500 x 350	508.0	355.6	381	356	508
20 x 12	500 x 300	508.0	323.9	381	346	508
20 x 10	500 x 250	508.0	273.1	381	333	508
20 x 8	500 x 200	508.0	219.1	381	324	508
24 x 22	600 x 550	610.0	559.0	432	432	508
24 x 20	600 x 500	610.0	508.0	432	432	508
24 x 18	600 x 450	610.0	457.0	432	419	508
24 x 16	600 x 400	610.0	406.4	432	406	508
24 x 14	600 x 350	610.0	355.6	432	406	508
24 x 12	600 x 300	610.0	323.9	432	397	508
24 x 10	600 x 250	610.0	273.1	432	384	508



FLANGES

Stainless Steel & Duplex Steel

- Stainless Steel : ASTM A 182F - 304/304H/304L/316/316H/316/316Ti
309, 310, 317L, 321, 347, 904L
- Duplex & Super Duplex : ASTM A182 - F51, F53, F55

Hi-Nickel & Titanium

Hi-Nickel

- Nickel : ASTM B 564 N02200, N02201
- Inconel : ASTM B 564 N06600, N06601, N06617
ASTM B 564 N07718, ASTM B 564 N06625
- Incoloy : ASTM B 564 N08800, N08810
ASTM B 564, N08825, ASTM B 564 N08020
- Hastelloy : ASTM B 564 N10276, N06022
ASTM B 564 N10665, ASTM B 564 N06455

Titanium

- Commercially : ASTM B 381 - Gr.1 R 56250 (CP4)
- Titanium Pure : Gr.2 R 50400 (CP3) Gr.3 R 50550 (CP2)
Gr.4 R 50700 (CP1) Gr.7 R 52400
Gr.11 R 52250
- Titanium Alloys : ASTM B 381 - Gr.5 R 56400 (6Al-4V)
Gr.23 R 56401 (6Al-4V-ELI)
Gr.12 R 53400

Cupro Nickel

- ASTM B 151 C70600 (90:10), ASTM B 151 C71500 (70:30)

Monel

- ASTM B 564 - N04400, N05500

Alloy Steel, Carbon Steel

- Alloy Steel : ASTM A 182 F 5, F 9, F 11,
F 12, F 22, F 91
- Carbon Steel : A105
- Low Temp. CS : ASTM A - 350 LF2

Size

- 15NB To 1200NB, ANSI B 16.5

Class

- 150#, 300#, 600#, 900#, 1500#, 2500#

Types

- | | |
|------------|--------------------|
| Weldneck | Screwed / Threaded |
| Socketweld | Long Weldneck |
| Slip on | Lapped Joint |
| Blind | Spectacle Blind |

Test Certificate

- Manufacturer Test Certification (En 3.1 & 3.2, IBR Test Certificate)

Specializing in :

Hi-Nickel & Stainless Steel Series

- Inconel®, Incoloy®, Monel®, Hastelloy®, Duplex®, are Registered Trade Marks of their Respective Owners.



FORGED FLANGES DIMENSIONS

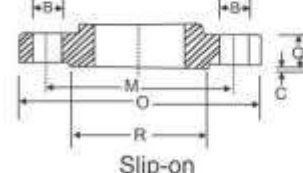
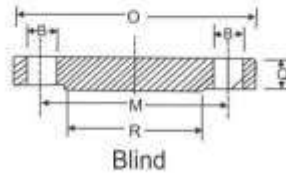
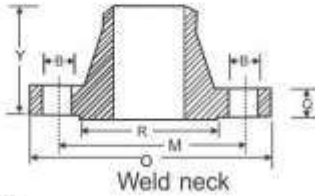

150 lbs

Normal pipe size (in mm)	Outside dia of flange	Minimum thickness of flange	Overall Length			bolt circle	No. and size of holes			O D of Raised face
			Welding neck	slip-on & socket welding	Lap joint		No.	B	R	
	O	Q	Y			Dia.m	No.	B	R	
15	89	11.2	47.6	15.9	15.9	60.5	4	15	35	
20	96	12.7	52.4	15.9	15.9	70.0	4	15	43	
25	108	14.3	55.6	17.5	17.5	79.5	4	15	51	
32	117	15.9	57.2	20.6	20.6	89.0	4	15	64	
40	127	17.5	61.9	22.2	22.2	98.5	4	15	73	
50	152	19.1	63.5	25.4	25.4	120.5	4	19	92	
65	178	22.3	69.8	28.6	28.6	139.5	4	19	105	
80	190	23.9	69.8	30.2	30.2	152.5	4	19	127	
90	216	23.9	71.4	31.8	31.8	178.0	8	19	140	
100	229	23.9	76.2	33.3	33.3	190.5	8	19	157	
125	254	23.9	88.9	36.5	36.5	216.0	8	22	186	
150	279	25.4	88.9	39.7	39.7	241.5	8	22	216	
200	343	28.6	101.6	44.4	44.4	298.5	8	22	270	
250	406	30.2	101.6	49.2	49.2	362.0	12	25	324	
300	483	31.8	114.3	55.6	55.6	432.0	12	25	381	
350	533	35.0	127.0	57.2	79.4	476.0	12	29	413	
400	597	36.6	127.0	63.5	87.3	539.5	16	29	470	
450	635	39.7	139.7	68.3	96.8	578.0	16	32	533	
500	698	42.9	144.5	73.0	103.2	635.0	20	32	584	
600	813	47.7	152.4	82.6	111.1	749.5	20	35	692	

300 lbs

Normal pipe size (in mm)	Outside dia of flange	Minimum thickness of flange	Overall Length			bolt circle	No. and size of holes			O D of Raised face
			Welding neck	slip-on & socket welding	Lap joint		No.	B	R	
	O	Q	Y			Dia.m	No.	B	R	
15	95	14.3	52.4	22.2	22.2	66.5	4	15	35	
20	117	15.9	57.2	25.4	25.4	82.5	4	19	43	
25	124	17.5	61.9	27.0	27.0	89.5	4	19	51	
32	133	19.1	65.1	27.0	27.0	98.5	4	19	64	
40	156	20.7	66.3	30.2	30.2	114.5	4	22	73	
50	165	22.3	69.8	33.3	33.3	127.0	8	19	92	
65	190	25.4	76.2	38.1	38.1	149.0	8	22	105	
80	210	28.6	79.4	42.9	42.9	168.0	8	22	127	
90	229	30.2	81.0	44.5	44.5	184.0	8	22	140	
100	254	31.8	85.7	47.6	47.6	200.0	8	22	157	
125	279	35.0	98.4	50.8	50.8	235.0	8	22	186	
150	313	36.6	98.4	52.4	52.4	270.0	12	22	216	
200	381	41.3	111.1	61.9	61.9	330.0	12	25	270	
250	444	47.7	117.5	66.7	95.3	387.5	16	29	324	
300	521	50.8	130.2	73.0	101.6	451.0	16	32	381	
350	584	54.0	142.9	76.2	111.1	514.5	20	32	413	
400	648	57.2	146.0	82.6	120.7	571.5	20	35	470	
450	711	60.4	158.8	88.9	130.2	628.5	24	35	584	
500	775	63.5	161.9	95.2	139.7	686.0	24	35	692	
600	914	69.9	168.3	106.4	152.4	813.0	24	41	692	

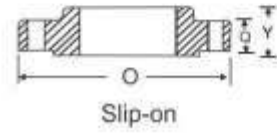
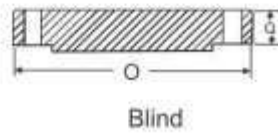
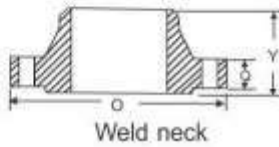

600 lbs

Normal pipe size (in mm)	Outside dia of flange	Minimum thickness of flange	Overall Length			bolt circle	No. and size of holes			O D of Raised face
			Welding neck	slip-on & socket welding	Lap joint		No.	B	R	
	O	Q	Y			Dia.m	No.	B	R	
15	95	14.3	52.4	22.2	22.2	66.5	4	15	35	
20	117	15.9	57.2	25.4	25.4	82.5	4	19	43	
25	124	17.5	61.9	27.0	27.0	89.5	4	19	51	
32	133	20.7	66.7	28.6	28.5	98.5	4	19	64	
40	156	22.3	69.8	31.8	31.8	114.5	4	22	73	
50	165	25.4	73.0	36.5	36.5	127.0	8	19	92	
65	190	28.6	79.4	41.3	41.3	149.0	8	22	105	
80	210	31.8	82.6	46.0	46.0	168.0	8	22	127	
90	229	35.0	85.7	49.2	49.2	184	8	25	140	
100	273	38.1	101.6	54.0	54.0	216.0	8	25	157	
125	330	44.5	114.3	60.3	60.3	266.5	8	29	186	
150	356	47.7	117.5	66.7	66.7	292.0	12	29	216	
200	419	55.6	133.4	76.2	76.2	349.0	12	32	270	
250	508	63.5	152.4	85.7	115.1	432.0	16	35	324	
300	559	66.7	155.6	92.1	111.1	489.0	20	35	381	
350	603	69.9	165.1	93.7	117.5	527.0	20	38	413	
400	686	76.2	177.8	106.4	127.0	603.0	20	41	470	
450	743	82.6	184.2	117.6	139.7	654.0	20	45	533	
500	813	88.9	190.5	127.0	165.1	724.0	24	45	584	
600	940	101.6	203.2	139.7	184.2	838.0	24	51	692	

900 lbs

Normal pipe size (in mm)	Outside dia of flange	Minimum thickness of flange	Overall Length			bolt circle	No. and size of holes			O D of Raised face
			Welding neck	slip-on & socket welding	Lap joint		No.	B	R	
	O	Q	Y			Dia.m	No.	B	R	
15	121	22.3	60.3	31.8	31.8	82.5	4	22	35	
20	130	25.4	69.8	34.9	34.9	89.0	4	22	43	
25	149	28.6	73.0	41.3	41.3	101.5	4	25	51	
32	159	28.6	73.0	41.3	41.3	111.0	4	25	64	
40	178	31.8	82.6	44.4	44.4	124.0	4	29	73	
50	216	38.1	101.6	57.2	57.2	165.0	8	25	92	
65	244	41.3	104.8	63.5	63.5	190.5	8	29	105	
80	241	38.1	101.6	54.0	54.0	190.5	8	25	127	
100	292	44.5	114.3	69.8	69.8	235.0	8	32	157	
125	349	50.8	127.0	79.4	79.4	279.5	8	35	186	
150	381	55.6	139.7	85.7	85.7	317.5	12	32	216	
200	470	68.5	161.5	101.8	114.3	393.5	12	38	270	
250	546	69.9	184.2	108.0	127.0	470.0	16	38	324	
300	610	79.4	200.0	117.5	142.9	533.5	20	38	381	
350	641	85.8	212.7	130.2	155.6	559.0	20	41	413	
400	705	88.9	215.8	133.4	165.1	616.0	20	45	470	
450	787	101.6	228.6	152.4	190.5	686.0	20	51	533	
500	857	108.0	247.6	158.8	209.6	749.5	20	54	584	
600	1041	139.7	292.1	203.2	266.7	901.5	20	67	692	



FORGED FLANGES DIMENSIONS

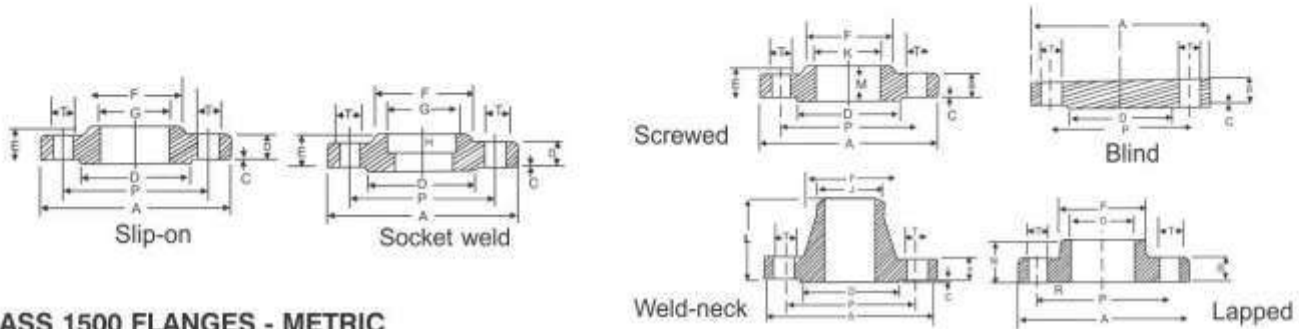

CLASS 1500 FLANGES - METRIC

N.B.	A	B	C	D	E	F	G	H	J	K	L	M	N	O	P	R	T	No. of Holes
15	121	22.2	6.4	35	32	38	22.4	9.5	21.3	23.5	60	22	32	23.0	82.6	3.0	22.2	4
20	130	25.4	6.4	43	35	44	27.7	11.0	26.7	29.0	70	25	35	28.0	88.9	3.0	22.2	4
25	149	28.6	6.4	51	41	52	34.5	12.5	33.4	36.0	73	29	41	35.0	101.6	3.0	25.4	4
32	159	28.6	6.4	64	41	64	43.2	14.5	42.2	44.5	73	30	41	43.5	111.1	5.0	25.4	4
40	178	31.8	6.4	73	44	70	49.5	16.0	48.3	50.5	83	32	44	50.0	123.8	6.5	28.6	4
50	216	38.1	6.4	92	57	105	62.0	17.5	60.3	63.5	102	38	57	62.5	165.1	8.0	25.4	8
65	244	41.3	6.4	105	64	124	74.7	19.0	73.0	76.0	105	48	64	75.0	190.5	8.0	28.6	8
80	267	47.6	6.4	127	73	133	--	--	88.9	92.0	117	51	73	91.5	203.2	9.5	31.8	8
100	311	54.0	6.4	157	91	162	--	--	114.3	118.0	124	57	91	17.0	241.3	11.0	34.9	8
125	375	73.0	6.4	186	105	197	--	--	141.3	145.0	156	64	105	145.0	292.1	11.0	41.3	8
150	394	82.6	6.4	216	119	229	--	--	168.3	171.0	171	70	119	171.0	317.5	12.5	38.1	12
200	483	92.1	6.4	270	143	292	--	--	219.1	222.0	213	76	143	222.0	393.7	12.5	44.4	12
250	584	108.0	6.4	324	159	368	--	--	273.0	276.0	254	84	178	277.0	482.6	12.5	50.8	12
300	673	123.8	6.4	381	181	451	--	--	323.9	329.0	283	92	219	328.0	571.5	12.5	54.0	16
350	749	133.4	6.4	413	--	495	--	--	356.6	--	298	--	241	360.0	635.0	12.5	60.3	16
400	826	146.1	6.4	470	--	552	--	--	406.4	--	311	--	260	411.0	704.8	12.5	6.7	16
450	914	161.9	6.4	533	--	597	--	--	457.2	--	327	--	276	462.0	774.7	12.5	73.0	16
500	984	178.0	6.4	584	--	641	--	--	508.0	--	356	--	292	514.0	831.8	12.5	79.4	16
600	1168	203.0	6.4	692	--	762	--	--	609.6	--	406	--	330	616.0	990.6	12.5	92.0	16

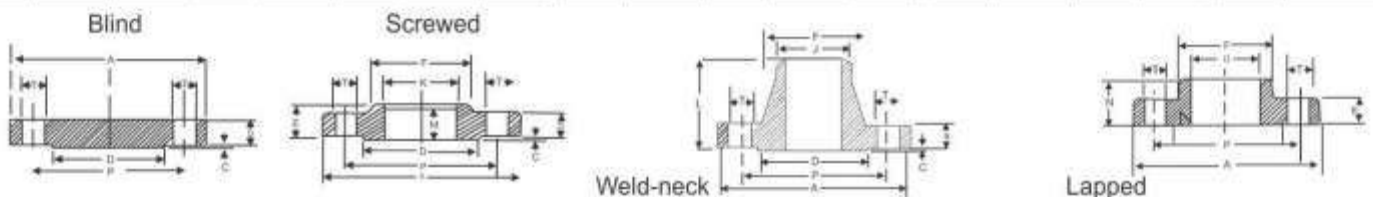

CLASS 2500 FLANGES - METRIC

N.B.	A	B	C	D	E	F	G	H	J	K	L	M	N	O	P	R	T	No. of Holes
15	133	30.2	6.4	35	40	43	--	--	21.3	23.5	73	29	40	23.0	88.9	3.0	22.2	4
20	140	31.7	6.4	43	43	51	--	--	26.7	29.0	79	32	43	28.0	95.2	3.0	22.2	4
25	159	34.9	6.4	51	48	57	--	--	33.4	35.0	89	35	48	35.0	107.9	3.0	25.4	4
32	184	38.1	6.4	64	52	73	--	--	42.2	44.5	95	38	52	43.5	130.2	5.0	28.6	4
40	203	44.4	6.4	73	60	79	--	--	48.3	50.5	111	44	60	50.0	146.0	6.5	31.8	4
50	235	50.8	6.4	92	70	95	--	--	60.3	63.5	127	51	70	62.5	171.4	8.0	28.6	8
65	267	57.1	6.4	105	79	114	--	--	73.0	76.0	143	57	79	75.5	196.8	8.0	31.8	8
80	305	66.7	6.4	127	92	133	--	--	88.9	92.0	168	64	92	91.5	228.6	9.5	34.9	8
100	356	76.2	6.4	157	108	165	--	--	114.3	118.0	190	70	108	117.0	273.0	11.0	41.3	8
125	419	92.1	6.4	186	130	203	--	--	141.3	145.0	229	76	130	145.0	323.8	11.0	47.6	8
150	483	108.0	6.4	216	152	235	--	--	168.3	171.0	273	83	152	171.0	368.3	12.5	54.0	8
200	552	127.0	6.4	270	178	305	--	--	219.1	222.0	318	95	178	222.0	438.1	12.5	54.0	12
250	673	165.1	6.4	324	229	375	--	--	273.0	276.0	419	108	229	277.0	539.7	12.5	66.7	12
300	762	184.1	6.4	381	254	441	--	--	323.9	329.9	464	121	254	328.0	619.1	12.5	73.0	12

*Minimum length.



HOUSE OF STAINLESS STEEL

Mob.: +91-9962492282 / 9884730542

✉ dbalajipurohit2008@yahoo.in 🌐 www.dbpipefittings.in



D BALAJI PIPE FITTINGS



FORGED FITTINGS

Stainless Steel & Duplex Steel

Stainless Steel : ASTM A 182F - 304/304H/304L/316/316H/316/316Ti
309, 310, 317L, 321, 347, 904L

Duplex & Super Duplex : ASTM A182 - F51, F53, F55

Hi-Nickel & Titanium

Hi-Nickel

Nickel : ASTM B 564 N02200, N02201

Inconel : ASTM B 564 N06600, N06601, N06617
ASTM B 564 N07718, ASTM B 564 N06625

Incoloy : ASTM B 564 N08800, N08810
ASTM B 564, N08825, ASTM B 564 N08020

Hastelloy : ASTM B 564 N10276, N06022
ASTM B 564 N10665, ASTM B 564 No6455

Titanium

Commercially : ASTM B 381

Titanium Pure Gr.1 R 56250 (CP4) Gr.2 R 50400 (CP3)
Gr.3 R 50550 (CP2) Gr.4 R 50700 (CP1)
Gr.7 R 52400 Gr.11 R 52250

Titanium Alloys : ASTM B 381
Gr.5 R 56400 (6Al-4V) Gr.23 R 56401 (6Al-4V-ELI)
Gr.12 R 53400

Cupro Nickel

ASTM B 151 C70600 (90:10), ASTM B 151 C71500 (70:30)

Monel

ASTM B 564 N04400, N05500

Alloy Steel, Carbon Steel

Alloy Steel : ASTM A 182 F 5, F 9, F 11,
F 12, F 22, F 91

Carbon Steel : A105

Low Temp. CS : ASTM A - 350 Lf2

Other Service : Hot Dip Galvanizing, Sand Blasting

Size

15NB To 100NB (Socket Weld & Threaded)

Class

3000#, 6000#, 9000#, In ANSI B 16.11

Types

Elbow (45 & 90 Deg)	Coupling
Tee	Cap
Union	Plug
Cross	Bushing
Swage Nipple	Boss

Test Certificate

Manufacturer Test Certification (En 3.1 & 3.2, IBR Test Certificate)

Specializing in :

Hi-Nickel & Stainless Steel Series

Inconel*, Incoloy*, Monel*, Hastelloy*, Duplex*, are Registered Trade Marks of their Respective Owners.



DIMENSION IN MM OF FORGED SCREWED FITTINGS TO ANSI B-16.11 THREADED TO ASA B 2.1

90° ELBOWS

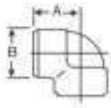

TEE

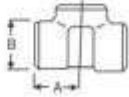

45° ELBOW

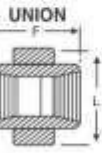

COUPLING

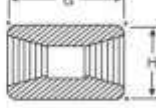

PIPE CAP

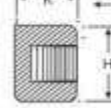

BUSHING

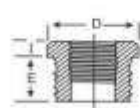

HEX HEAD PLUG

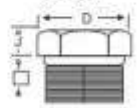

HALF COUPLING = G/2

NOM BORE	PIPE O.D.	3000 L.B.S						COMMON FACTORS						6000 L.B.S					
		A	B	C	G	H	K	D	E	F	I	J	L	A	B	C	G	H	K
1/8"	10.3	21	22	17	32	16	19	11	10	40	-	6	-	25	25	19	32	22	-
1/4"	13.7	25	25	19	35	19	25	16	11	43	3	6	32	29	33	22	35	25	27
3/8"	17.2	29	33	22	38	22	25	17.5	13	48	4	8	38	33	38	25	38	32	27
1/2"	21.3	33	38	25	48	29	32	22	15	51	5	8	46	38	46	29	48	38	33
3/4"	26.7	38	46	29	51	35	37	27	16	57	6	10	51	44	56	33	51	44	38
1"	33.4	44	56	33	60	44	41	35	19	64	6	10	60	51	62	35	60	57	43
1 1/4"	42.2	51	62	35	67	57	44	44.5	21	70	7	14	72	60	75	43	67	64	46
1 1/2"	48.3	60	75	43	79	64	44	51	21	79	8	16	80	64	84	44	79	76	48
2"	60.3	64	84	45	86	76	48	63.5	22	88	9	17	94	83	102	52	86	92	51
2 1/2"	73.02	83	102	52	92	92	60	76	27	118	10	21	122	95	121	64	92	108	64
3"	89.0	95	121	64	108	108	65	89	29	121	10	25	140	106	146	79	108	127	68
4"	114.5	114	152	79	121	140	68	117.5	32	150	13	25	180	114	152	79	121	159	75

SOCKET WELD FITTING TO ANSI B-16.11

90° ELBOWS

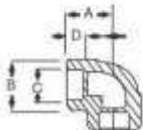

TEE

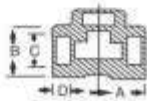

45° ELBOW



UNION

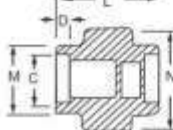

COUPLING

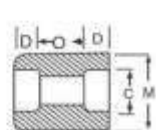

REDUCER

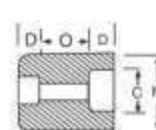

HALF COUPLING

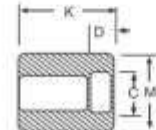

CAP

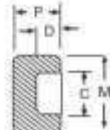

NOM BORE	PIPE O.D.	3000 L.B.S									COMMON FACTORS				6000 L.B.S				
		A	B	K	J	L	M	N	P	Q	Cmin	Dmin	Omin	Omax	A	B	M	K	N
1/8"	10.3	22	18.5	26	16	40	17.3	32	17.5	10	10.7	10	5	8	22	22	20	25	46
1/4"	13.7	22	22	26	18	43	21.2	32	17.5	10	14.1	10	5	8	27	25	24	25	51
3/8"	17.2	25	25	26	19	48	25.4	36	19	10	17.6	10	3	9	27	28	28	26	60
1/2"	21.3	27	32	30	21	51	31	43	22	10	21.7	10	6	13	31	34	34	31	72
3/4"	26.7	34	38	36	24	57	37	50	25	13	27	13	6	13	37	42	41	35	80
1"	33.4	37	46	40	25	64	45.2	60	27	13	33.8	13	9	17	42	50	50	40	94
1 1/4"	42.2	42	56	40	29	70	55	70	30	13	42.6	13	9	17	47	59	58	41	100
1 1/2"	48.3	47	62	40	30	79	61.4	78	32	13	48.7	13	9	17	53	67	55	43	122
2"	60.3	56	75	52	37	89	75	95	38	13	61.2	16	15	23	59	84	83	55	
2 1/2"	73.02	60	92	52	48	114	91.3	125	38	16	73.8	16	14	24		102		56	
3"	89.00	76	110	52	51	127	108.8	140	44	16	89.8	16	14	24		121		58	
4"	114.50	88	137	58		150	136.9		48	19	115.5	19	14	24		152		64	

DIMENSIONS AND OTHERS SPECIFICATIONS AS PER CUSTOMERS REQUIREMENTS ARE AVAILABLE ON REQUEST



PIPES & TUBES

Stainless Steel & Duplex Steel

Stainless Steel : ASTM A 312, 249, 269, 312, 358 - TP 304, 304L, 316L, 316Ti, 309, 310, 317, 317L, 321, 347, 904L, SMO 254

Duplex & : Standard

Super Duplex : ASTM A 789, 790 - UNS S31803, S32205 (2205)

Lean

ASTM A 798, 790 - UNS S32304 (2304)

Super Duplex

ASTM 789, 790, - UNS S32750 (2507)

UNS S32760 (Zeron 100)

Hi-Nickel & Titanium

Hi-Nickel

Nickel : ASTM B 161, 622 - N02200, N02201

Inconel : ASTM B 167, 517, 163 - N06600, N06601, N06617
ASTM B 444 - N07718, ASTM B 444, 705 - N06625

Incoloy : ASTM B 407, 154, 163, 515 - N08800, N08810
ASTM B 423 - N08825, ASTM B 729, 464, 468-N08020

Hastelloy : ASTM B 622, 619, 626 - N10276, N06022,
N10665, N06455

Titanium

Commercially : ASTM B 861, 862, 338

Pure : Gr.1 R 56250 (CP4) Gr.2 R 50400 (CP3)
Gr.3 R 50550 (Cp2) Gr.4 R 50700 (Cp1)
Gr.7 R 52400 Gr.11 R 52250

Alloys : ASTM B 861, 862, 338
Gr.5 R 56400 (6Al-4V)
Gr.23 R 56401 (6Al-4V-ELI)
Gr.12 R 53400

Cupro Nickel

ASTM B466, B111 - C70600 (90:10), C71500 (70:30)

Monel

ASTM B165, B 725, B163 - N04400, N05500

Alloy Steel, Carbon Steel & LTCS

Alloy Steel Pipes : ASTM A335 GR. P5, P9, P11, P22 & P91

Alloy Steel Tubes : ASTM A 213 - T-11, T-12, T-22
: T-5, T-9 etc.

Carbon Steel Pipes : ASTM A 106 Gr. B, ASTM A53

Carbon Steel Tubes : BS 3059 Gr. 360 / 440, SA 179,
SA / ASTM A210 Gr. A1

Low Temp. (LTCS) : ASTM A 333 Gr. 6

Line Pipe : API 5L, X 42, 46, 52, 56, 60, 70

Mild Steel & Galvanized: IS 1239, IS 3589

Size

Pipes : 1/4" to 48"

Schedule : Sch. 5 to Sch. XXS

Tubes : 6 mm OD to 219.08 mm OD

Thickness : 0.6mm-10mm-Gauge : SWG/BWG
to 10 SWG/BWG

Form : Round, Square, Rectangle, Coil, 'U' Shape

Length : Standard Length & Cut Length

Test Certificate

Manufacturer Test Certification (En 3.1 & 3.2, IBR Test Certificate)

Specializing in :

Large Diameter CS Pipes & Duplex Steel

Inconel®, Incoloy®, Monel®, Hastelloy®, Duplex®,

are Registered Trade Marks of their Respective Owners.



PIPES & TUBES



Items dealt by us are Guaranteed and we provide Mill Test Certificate / Government Approved Lab Test Certificate with the supplies. Third Party Inspection by any Reputed Organization like LLOYDS, EIL, PDIL, BVIS, DNV etc. is accepted by us. These Listed items most of which we can supply Ex-stock or within a very Short Delivery period at very competitive rate with specified material & Quality Assurance plan therefore we request you to honour of being on your list of approved Suppliers.

PIPE & TUBE

Manufacture

Our company is India's largest manufacturer of stainless steel in 200 series, 300 series (including Stainless Steel) ASTM A312, 249, 269, 312, 358, TP 304, 304L, 316L, 310, 321 series and duplex stainless steel grades. Our product range includes Stainless Steel Seamless Pipe / Semi Seamless Pipe & ERW Pipe. Combining an experience of over four decades, a clear focus on customer needs, cross market expertise, a wide range of products and modern technology has been the mainstay of our success. All the products manufactured by authentic raw material by Jindal / Essar / SAIL and all other brands.



Seamless Pipe & Tube
 Welded Pipe & Tube
 Thick-walled Pipe & Tube
 Capillary Tube
 Sanitary Pipe & Tube
 Square Pipe & Tube
 Rectangle Pipe & Tube
 Cold Tube



स्टील अथॉरिटी ऑफ इण्डिया लिमिटेड
 STEEL AUTHORITY OF INDIA LIMITED



STAINLESS STEEL PIPE DIMENSION AS PER ASTM AND WEIGHT KG. PER MTR. (ANSI B 36.19)

Nominal Bore		Outside Diameter	Schedule 5S		Schedule 10S		Schedule 20S		Schedule 40S		Schedule 80S		Schedule 160S		Schedule XXS	
mm	Inch	mm	Wt mm	Weight (Kg/mt)	Wt mm	Weight (Kg/mt)	Wt mm	Weight (Kg/mt)	Wt mm	Weight (Kg/mt)	Wt mm	Weight (Kg/mt)	Wt mm	Weight (Kg/mt)	Wt mm	Weight (Kg/mt)
3	1/8	10.3	1.24	0.276	1.24	0.28	1.5	0.33	1.73	0.37	2.41	0.47	-	-	-	-
6	1/4	13.7	1.24	0.390	1.65	0.49	2.00	0.58	2.24	0.631	3.02	0.80	-	-	-	-
10	3/8	17.1	1.24	0.490	1.65	0.63	2.00	0.74	2.31	0.845	3.20	1.10	-	-	-	-
15	1/2	21.3	1.65	0.800	2.11	1.00	2.30	1.07	2.77	1.27	3.75	1.62	4.75	1.94	7.47	2.55
20	3/4	26.7	1.65	1.03	2.11	1.28	2.55	1.52	2.87	1.68	3.91	2.20	5.54	2.89	7.82	3.63
25	1	33.4	1.65	1.30	2.77	2.09	2.55	1.94	3.38	2.50	4.55	3.24	6.35	4.24	9.09	5.45
32	1.1/4	42.2	1.65	1.65	2.77	2.70	3.00	2.90	3.56	3.38	4.85	4.47	6.35	5.61	9.70	7.77
40	1.1/2	48.3	1.65	1.91	2.77	3.11	3.00	3.55	3.68	4.05	5.08	5.41	7.14	7.25	10.16	9.54
50	2	60.3	1.65	2.40	2.77	3.93	3.00	4.24	3.91	5.44	5.54	7.48	8.74	11.1	11.07	13.44
65	2.1/2	73.0	2.11	3.69	3.05	5.26	4.00	6.81	5.16	8.63	7.01	11.4	9.53	14.9	14.2	20.39
80	3	88.9	2.11	4.51	3.05	6.45	4.00	8.37	5.49	11.30	7.62	15.2	11.1	21.3	15.24	27.65
100	4	114.3	2.11	5.84	3.05	8.36	4.50	12.18	6.02	16.07	8.56	22.3	13.49	33.54	17.12	41.03
125	5	141.3	2.77	9.47	3.40	11.57	5.00	16.80	6.55	21.8	9.53	31.97	15.88	49.11	19.05	57.43
150	6	168.3	2.77	11.32	3.40	13.84	6.35	25.36	7.11	28.3	10.97	42.7	18.2	67.56	21.95	79.22
200	8	219.1	2.77	14.79	3.76	19.96	6.35	33.31	8.18	42.6	12.7	64.6	23.0	111.2	22.23	107.8
250	10	273.1	3.40	22.63	4.19	27.78	6.35	41.77	9.27	60.5	12.7	96.0	28.6	172.4	25.40	155.15
300	12	323.9	3.96	31.25	4.57	36.00	6.35	49.7	9.52	73.88	12.7	132.0	33.32	238.76	25.40	186.97
350	14	355.6	3.96	34.36	4.78	41.3	7.92	67.80	11.13	94.59	19.05	158.08	35.71	281.70	-	-
400	16	406.4	4.19	41.56	4.78	47.29	7.92	77.83	12.7	123.30	21.41	203.33	40.46	365.11	-	-
450	18	457.2	4.19	46.80	4.78	53.42	7.92	87.71	14.27	155.80	23.8	254.36	45.71	466.40	-	-
500	20	508.0	4.78	59.25	5.54	68.71	9.53	117.14	15.09	183.42	26.19	311.2	49.99	564.68	-	-
600	24	609.6	5.54	82.47	6.35	94.45	9.53	141.12	17.48	255.41	30.96	442.08	59.54	808.22	-	-



COMPRESSION TUBE FITTINGS

Accessories



Front Ferrule



Back Ferrule



Ferrule Nut

Tube to Male Connection



Male Connector



Male Elbow



Male Bulkhead Connector



Male Run Tee

Tube to Female Connection



Female Connector



Female Elbow



Female Bulkhead Connector



Female Run Tee



Female Branch Tee

Tube to Union Connection



Union



Union Elbow



Union Tee



Union Cross



Bulkhead Union



Reducing Union

Instrumentation Pipe Fittings



Male Tee



Female Tee



Street Tee



Branch Tee



Female Cross



Male Elbow



Female Elbow



Street Elbow



Adapter



Bushing



Hex Coupling



Reducing Hex Coupling



Hex Nipple



Reducing Hex Nipple

SPECIFICATION

Available Grade : Nickel Alloys (Inconel / Monel / Hastelloy / Nickel / SMO254) Cupro-Nickel / Duplex / Super Duplex / Titanium / Stainless Steel

Size : 1/16" OD to 2" OD & 2 MM OD to 50 MM OD

Perssure Rating : Upto 6000 PSI

Thread : NPT, BSP, BSPT, BSPP, UNF, ISO, SAF, Etc.

Temperature Rating: Upto 426°C

PTFE Standard : ASTM A1710, ASTM D3294

Certification : En 10204 Type 3.1



Hex Plug



Female Cap



FASTENERS



TYPE OF BOLTS

- Hex Head Bolt
- Socket Cap Screw
- Carriage Bolt
- Flange Bolt
- Elevator Bolt
- Machine Bolt
- Grub Screw
- Set Screw
- Anchor Bolt
- Eye Bolt
- Hanger Bolt
- U Bolt
- J Bolt

TYPE OF NUTS

- Hex Nut
- Heavy Hex Nut
- Cap Nut
- Coupling Nut
- High Nut
- Flange Lock Nut
- Nylon Lock Nut
- Slotted Nut
- Custom Nut
- Wing Nut
- Jam Nut
- T Nut

TYPE OF SCREWS

- Self Drilling Screw
- Self Tapping Screw
- Machine Screw
- Particle Board Screw
- Roofing Screw
- Construction Screw
- Furniture Screw
- Wing Screw
- Cap Screw

TYPE OF WASHERS

- Flat Washer
- Spring Washer
- Dome Washer
- Countersunk Washer
- Hex Washer
- Lock Washer
- Square Washer
- Customized Washer

Stainless Steel : AISI 304,304L,316,316L, 310, 317, 317L, 321, 347, 410, 420,904L etc.

Alloy Steel : 4.6, 5.6, 6.6, 8.8, 10.9 & 12.9 / 'R', 'S', 'T' Conditions.

Carbon Steel : Bare Condition, Galvanized, Phosphetised, Cadium Plated, Hot Deep Galvanized, Bloodied, Nickel Chrome Plated,etc.

High Nickel Alloy : Monel, Nickel, Inconel, Hastelloy

Others : Copper, Brass, Bronze, Titanium, Tantalum, Bismuth, Aluminium, High Speed Steel, Zinc, Lead, etc.



HOUSE OF STAINLESS STEEL

Mob.: +91-9962492282 / 9884730542

✉ dbalajipurohit2008@yahoo.in 🌐 www.dbpipefittings.in



D BALAJI PIPE FITTINGS

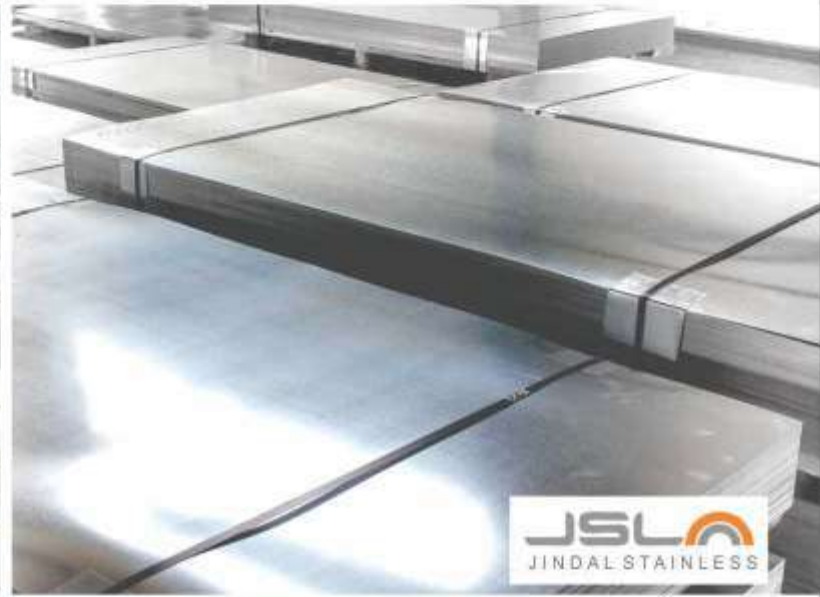

SHEET / PLATE / COIL / SHIMS

Stainless Steel & Duplex Steel

- Stainless Steel : ASTM A 240, 304/304L/316/316L/316TI/309/310/
317/317L/321/347/409/410/430/
904L/SMO 254/AL6N
- Duplex & Super Duplex : Standard
ASTM A240 - UNS S31803/S32205 (2205)
Lean
ASTM A240 - UNS S32304 (2304)
Super Duplex
ASTM A240 - UNS S32750 (2507)
ASTM A240 - UNS S32760 (Zeron 100)

Hi-Nickel & Titanium

Hi-Nickel

- Nickel : ASTM B 162 N02200, N02201
- Inconel : ASTM B 168 N06600, N06601, N06617
ASTM B 670 N07718, ASTM B 443 N06625
- Incoloy : ASTM B 409 N08800, N08810
ASTM B 424 N08825, ASTM B 462 N08020
- Hastelloy : ASTM B 575 N10276, N06022
ASTM B 333 N10665

Titanium

- Commercially : ASTM B 265
- Titanium Pure : Gr.1 R 56250 (CP4) Gr.2 R 50400 (CP3)
Gr.3 R 50550 (CP2) Gr.4 R 50700 (CP1)
Gr.7 R 52400
- Titanium Alloys : ASTM B 265
Gr.5 R 56400 (6Al-4V)
Gr.23 R 56401(6Al-4V-ELI)
Gr.12 R 53400

Cupro Nickel

- ASTM B 171 C70600 (90:10), C71500 (70:30)

Monel

- ASTM B127 N04400, DIN N05500

Alloy Steel, Carbon Steel / Mild Steel

- Alloy Steel Pipe : ASTM A387 Gr. 11, 12, 22, 5, 91 (CL 1/2)
WP 12, WP 22, WP 91
- Carbon Steel : ASTM A 36, S275 JR, IS 2062 Gr. A/B

Boiler Quality

- SA 516 Gr. 70

Hardox

- Hardox 400/500

Size

- Sheets : 0.5mm to 4mm Thk. in 1000 upto
2000mm Width & 2000 upto 6000 Length
- Plates : 5mm to 100 mm Thk. in 1000 upto
2000mm Width & 2000 upto 8000 Length
- Coils : 0.1mm Thk. to 12mm Thk. in 10mm upto
1500 Width
- Foils : 0.01mm Thk. to 0.3mm Thk. in any Width
- Strips : 1mm Thk. to 100mm Thk. in 10mm upto
Width & 1000 upto 6000 Length

Test Certificate

- Manufacturer Test Certification (En 3.1 & 3.2, IBR Test Certificate)

Specializing in :

Hi-Nickel & Stainless Steel Series

- Inconel*, Incoloy*, Monel*, Hastelloy*, Duplex*,
are Registered Trade Marks of their Respective Owners.

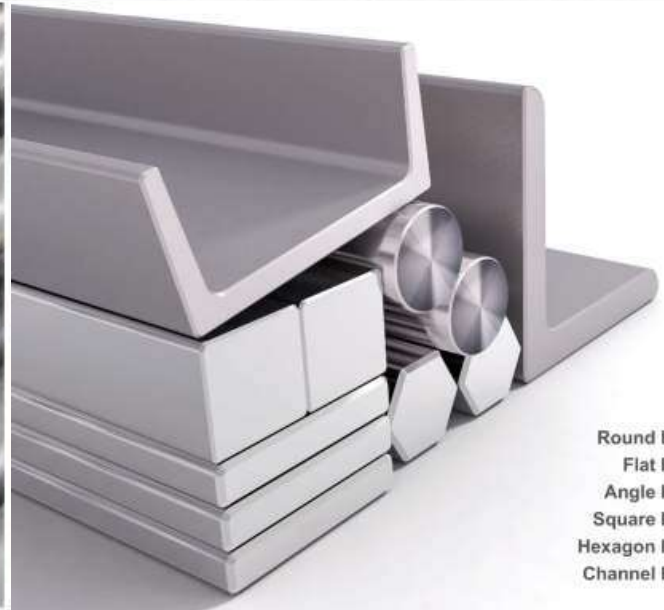

Round Bar
Flat Bar
Angle Bar
Square Bar
Hexagon Bar
Channel Bar

ROUND BARS & FLAT BARS

Stainless Steel & Duplex Steel

Stainless Steel : ASTM A276, A479 - 304/304L/316/316L/316Ti/309/310/317/317L/321/347/409/410/430/904L/SMO 254
Duplex & Super Duplex : Standard ASTM A276, A479 - UNS S31803/S32205 (2205) Lean UNS S32304 (2304) Super Duplex UNS S32750 (2507) UNS S32760 (Zeron 100)

Hi-Nickel & Titanium

Hi-Nickel

Nickel : ASTM B160 - N02200, N02201
Inconel : ASTM B166 - N06600, N06601, N06617
ASTM B637 - N07718, ASTM B446 - N06625
Incoloy : ASTM B408 - N08800, N08810
ASTM B408 - N08825, ASTM B473 - N08020
Hastelloy : ASTM B574 - N10276, ASTM B574 - N06022
ASTM B335 - N10665

Titanium

Commercially : ASTM B348 - Gr.1 R 56250 (CP4) Gr.2 R 50400 (CP3)
Gr.3 R 50550 (CP2) Gr.4 R 50700 (CP1)
Gr.7 R 52400
Titanium Alloys : ASTM B348 - Gr.5 R 56400 (6Al-4V)
Gr.23 R 56401(6Al-4V-ELI)
Gr.12 R 53400

Cupro Nickel

ASTM B151 - C70600 (90:10), C71500 (70:30)

Monel

ASTM B164 - N04400, ASTM B865 - N05500

Alloy Steel, Carbon Steel / Mild Steel

Alloy Steel : ASTM A182 - F 5, F 9, F 11, F 12, F 22, F 91
Carbon Steel : A105

Size

Size : 2 MM to 500 MM Dia
Length : 500 MM to 6000 MM long and in cut to Size
Form : Round, Square, Hex (A/F), Rectangle, Flat etc.
Finish : Bright, Polish & Black

Test Certificate

Manufacturer Test Certification (En 3.1 & 3.2, IBR Test Certificate)

Specializing in :

Hi-Nickel & Stainless Steel Series

Inconel[®], Incoloy[®], Monel[®], Hastelloy[®], Duplex[®], are Registered Trade Marks of their Respective Owners.



FORMULA

- 1) **WEIGHT OF STAINLESS STEEL PIPES & TUBES**
OD (mm) - W.T. (mm) X W.T. (mm) X 0.02466 = Kg. per Mtr.
- 2) **SHEET WIDTH REQUIRED FOR ROLLED AND WELDED PIPES**
O.D. (mm) - THK (mm) X 3.14 = Sheet Width
- 3) **WEIGHT OF STAINLESS STEEL SHEETS**
Length (mtr.) x Wdth (mtr.) X Thk (mm) X 8 = Kg Per Sheet
- 4) **WEIGHT OF STAINLESS STEEL CIRCLE & BLANKS**
O.D. (mm) X O.D.> (mm) X Thk (mm) /160/1000 = Kg Per Pcs.
- 5) **WEIGHT OF STAINLESS STEEL ROUNDS**
Dia. (mm) X Dia. (mm) X 0.00623 = Per Mtr.
- 6) **WEIGHT OF STAINLESS STEEL HEXAGONAL RODS**
Dia. (mm) X Dia. (mm) X 0.00679 = Per Mtr.
- 7) **WEIGHT OF STAINLESS STEEL SQUARE BARS**
Dia. (mm) X Dia. (mm) X 0.00787 = Kg Per Mtr.
- 8) **WEIGHT OF CARBON STEEL PIPES & TUBES**
O.D. (mm) - W.T. (mm) X W.T. (mm) X 0.02466 = Kg. Per Mtr.
- 9) **WEIGHT OF CARBON STEEL SHEETS - PLATES**
Length (mtr.) X Width (mtr.) X Thk (mm) X 7.85 = Kg. Per Sheet
- 10) **WEIGHT OF COPPER PIPES**
O.D. (mm) - W.T. (mm) X W.T. (mm) X 0.0256 = Kg. Per Mtr.
- 11) **WEIGHT OF LEAD PIPES (appro.)**
O.D. (mm) - W.T. (mm) X W.T. (mm) X 0.0345 = Per Mtr.
- 12) **WEIGHT OF LEAD SHEETS (appro.)**
Length (mtr.) X Width (mtr.) X Thk (mm) X 11.2 = Kg. Per Sheet
- 13) **WEIGHT OF ALLUMINIUM PIPES (appro.)**
O.D. (mm) - W.T. (mm) X W.T. (mm) X 0.0082 = Kg. Per Mtr.
- 14) **WEIGHT OF ALLUMINIUM SHEETS (appro.)**
Length (mtr.) X Width (mtr.) X Thk (mm) X 2.66 = Kg Per Sheet
- 15) **MAKING OF PIPE FROM SHEET OR PLATE**
OD - Thickness x 3.14 = Width of Sheet or Plate



APPLICATION INDUSTRIES

- Natural Gas
- Water Disposal
- Chemical Engineering
- Cement Industries
- Refinery Plants
- Oil & Gas
- Power
- Ship Building

THIRD PARTY INSPECTION





D BALAJI **PIPE FITTINGS**

**Stainless Steel UNS S30400 / S30403 Sheets, Plates, Coil,
SS Sheets, Plates & Coil Stainless Steel Sheets, Plates & Coil**

**Supplier Stainless Steel DIN 1.4301 / 1.4306 /
1.4307 Sheets, Plates & Coil Supplier**

D Balaji Pipe Fittings & Exporting of high quality stainless steel 304 sheets, stainless steel 304L plates, stainless steel 304 coils in thickness of 0.8 mm to 120 mm that have found extensive applications in various industries. We also deal in Nickel and Copper, Alloy, Stainless & Duplex Steel, Carbon & Alloy Steel are the materials which are used for designing of stainless steel sheets, plate and coil. We offer various grades of stainless steel plates & stainless steel sheets link SS 310 plates, SS 317 sheets & SS 321 plates etc.

Factory : Pato Pandora Tatak Voki Rada Road, Magan Fest, Munchal, Maharashtra - 401 202.

Mobile : +91-9962492282 +91-9884730542 Whatsapp : +91-9444522558+91-6374260316

Email : dbalajipipes 2008@gmail.com / dbalajipurohit2008@yahoo.in / internationaldbalaji 2008@gmail.com

Web : www.dbpipefittings.in